

DO NOT WRITE IN THIS BLOCK

PERMIT NO.

CODE 01	ACCOUNT NO. 0700	APPVL. DATE Jul 7 1969	FEE 10.00	PERMIT NO. 6583
INDEX NUMBER		ZONING R-2	P. C. CODE	USDC 21
CENSUS TR. 48	OWNERSHIP 1 <input type="checkbox"/> PRIVATE 2 <input type="checkbox"/> PUBLIC	MAP 7	LOCATION 1 <input checked="" type="checkbox"/> CITY 2 <input type="checkbox"/> PERIMETER 3 <input type="checkbox"/> COUNTY	
BOND POLICE: 4-03	LICENSE: FIRE LIMITS: No	PLANS? TRAFFIC:	CONSTR. 0 SEPTIC TANK: HEALTH DEPT:	

NOTE: SEPARATE PERMITS ARE REGD. FOR SIGNS, ELECTRICAL, PLUMBING, MECHANICAL WORK.

NUMBER 1704	STREET PATTON AVENUE 1704	LOT: BL:
----------------	------------------------------	-------------

PLOT PLAN: DRAW PLAN ACCURATELY, FROM SURVEY IF POSSIBLE. SHOW DIMENSIONS OF LOT AND LOCATE BUILDINGS BY DIMENSIONS FROM PROPERTY LINES. DIMENSION BUILDING.

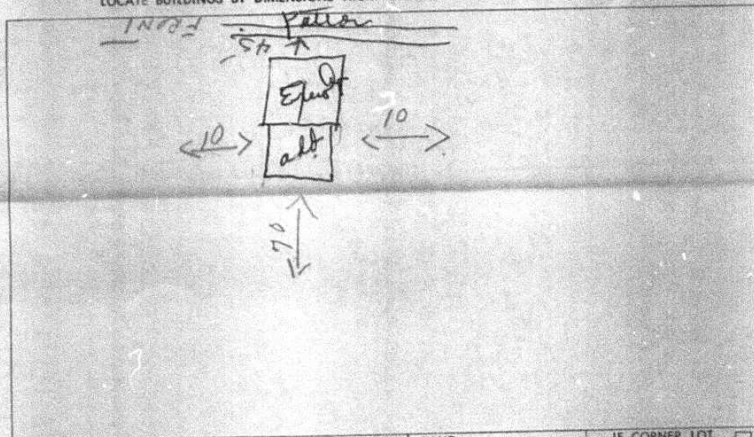

NAME OF SUBDIVISION	LAND AREA	IF CORNER LOT CHECK HERE <input type="checkbox"/>
---------------------	-----------	---

OWNER: W. L. GreeneADDRESS: Same

ARCH. OR ENGR:

ADDRESS:

CONTRACTOR: OwleyADDRESS: Same

PURPOSE OF BLDG: <u>Res. Addition</u>	NO ROOMS HABITABLE:	BSMT? <input type="checkbox"/>	NO. STORIES: <u>1</u>
CONNECTED TO CITY	• WATER? <u>Yes</u>	TYPE HEAT: <u>Gas</u>	CHIMNEY: NO. SIZE:
OR COUNTY SYSTEM	• SEWER? <u>Yes</u>	FUEL:	
GEN. CONSTR. COST (INCL. FIRE SPRINKLERS IF ANY). (NEAREST \$ 100) \$ <u>4,200.</u> CONTRACTOR			
ELECTRICAL	\$ <u>300.</u>		
PLUMBING	\$ <u>600.</u>		
HEATING	\$ <u>900.</u>		
OTHER	\$		
TOTAL COST	\$ <u>6,000.</u>	FLOOR AREA HEATED: <u>780</u>	NO. BATHS: <u>1</u>
DWELLING UNITS	• EXISTING	FLOOR AREA UNHEATED:	
	• ADDED		

THE UNDERSIGNED HEREBY MAKES APPLICATION TO BUILD REPAIR REMODEL EXTEND MOVE DEMOLISH OTHER _____
A BUILDING OR STRUCTURE AT THE LOCATION DESIGNATED ABOVE AND AGREES TO COMPLY WITH ALL LAWS APPLICABLE THERETO.

REMARKS: Room Addition to be used as bedroom & bath

SIGNATURE OF APPLICANT

W. L. Greene
DATE 7-7-69

APPROVALS
BUILDING: W.E.G.
ZONING: Duz
FEE: \$ 10.00

BUILDING INSPECTION DEPT.
CITY OF CHARLOTTE — NORTH CAROLINA

ORIGINAL (RECORD)

LGHE

R-2

PERMIT

No 7531

All construction work covered by this permit must conform to all City Ordinances and laws of the State of North Carolina regulating the work specified.

Temporary Privy must be installed before construction starts.

Permit is hereby issued to

Carlina Insulating & Co.
Date Sept. 29 1968