

PLOT PLAN: Draw plot plan accurately from survey if possible. Show dimensions of lot and locate all buildings by dimensions from property lines. Dimension all buildings. Indicate entrance doors.

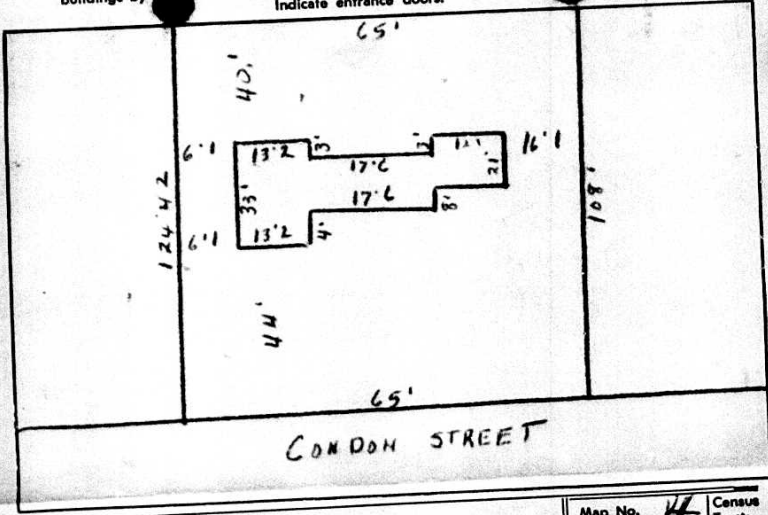

Number	Street
915	CONDON STREET
Street Width:	Twnshp. Lot Blk.
Owner:	GEORGE W. MORELAND
Address:	CHARLOTTE, N.C.
Arch. or Engr.:	
Address:	T.R. HELMS CONST. CO.
Address:	710 STATE STREET
Purpose of Bldg.:	RESIDENCE
Bldg. Area:	1024
No. Habitable Rms.:	5
No. Bath Rms.:	1
Basmt.?	no
Estimated Cost:	6,765.00
To be installed but not included in above cost:	
Electrical:	295.00
Plumbing:	795.00
Heating:	495.00
Sprinklers:	
Other:	
Total Cost:	8350.00

Map No.	44	Census Tract	
N.			48
E.			
Zone:	R-6		
Occupancy:			
Type of Const.:	B.UEN.		
Fire Limits?			
Setback?			
Plans?			
Septic Tank:			
Council:			
Raleigh:			
Traffic Engr.:			
Health:			
Bond?	yes		
License?			
Incinerator?			
Type Heat:	F.H.A.		
Fuel:	GAS		
Type Chimney:	METAL	No.	1
Size:	6"		

To the Inspection Department
City of Charlotte, N. C.

The undersigned hereby makes application to build repair remodel move demolish _____ a building or structure at the location designated above and agrees to conform to all applicable laws of the City of Charlotte and the State of North Carolina.

Remarks:

Signature of Applicant: T.R. Helms Const. Co. by P.H. Helms
 Contractor Owner
 - Not valid unless validated and approved below.

CITY PERIMETER ZONING
 Permit No. 77698 Date 2-2-61 Type Clerk Fee 1350.00
 Date of Application: June 22, 1969
 FILE COPY
 Approver: _____

To the Inspection Department
City of Charlotte, N. C.

The undersigned hereby makes application for the electrical installation form to all applicable laws of North Carolina regulating the same.

Contractor: Hastings
 Contractor's Address: 409
 Electrician in charge: P.H. Helms
 Building Owner: _____
 Building Owner's Address: _____
 Work will be ready for inspection _____
 Wiring Method: _____
 Remarks: (Describe Unclassified Work) _____

Signature of Applicant: Rough

Number	Street
915	CONDON
For the following:	No.
Size Service, in amps.	100
Meter Boxes	1
Outlets	3
Fixtures	1
Ranges	1
Water Heaters	
Barbecues	1
Unit Heaters	
Duct Heaters	
Heat Panels	
Heat Cables	
Sub-Total	
Fees to be entered by Inspection Department.	
PERMIT — Not valid	
ELECTRICAL	
Permit No.	7916

To the Inspection Department
City of Charlotte, N. C.

Date of Application: 4-6-64

The undersigned hereby makes application for permit and inspection of the mechanical installation at the premises described below, and agrees to conform to all applicable laws of the City of Charlotte and the State of North Carolina.