

buildings by dimensions from property lines. Dimension all buildings. Indicate entrance doors.

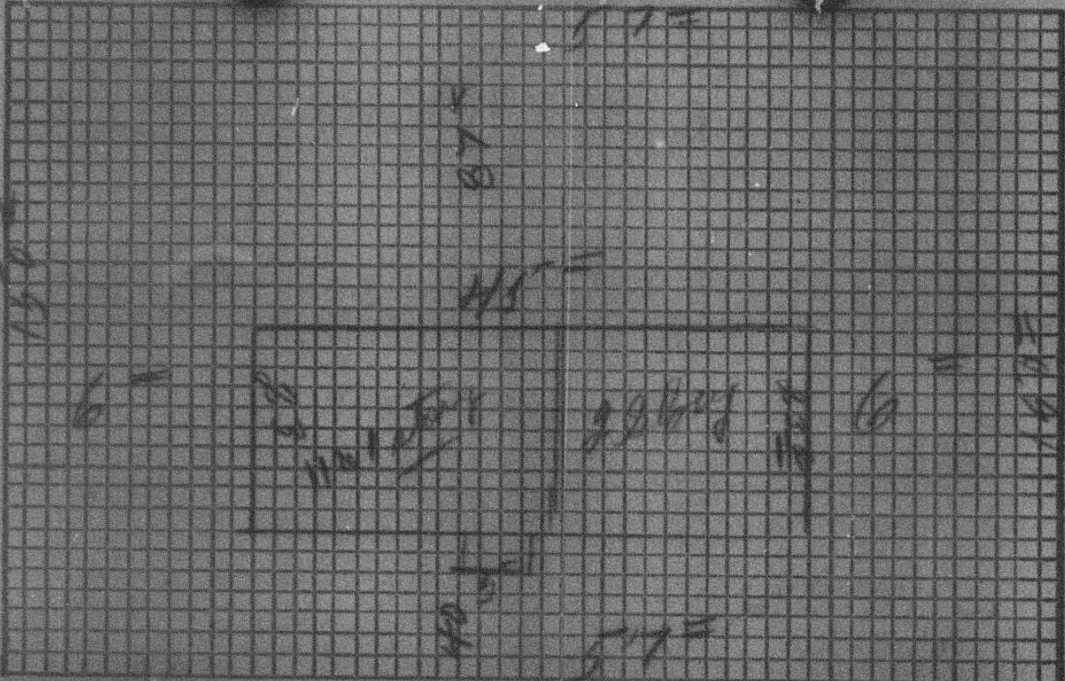

Number <b>1612</b>	Street <b>Madison Drive</b>		
Street Width:	Twnshp.	Lot	Blk.
Owner:	<b>Mr. &amp; Mrs. Richard A. Stewart</b>		
Address:	<b>1328 Norfolk Avenue</b>		
Arch. or Engr.:			
Address:			
Contractor:	<b>G. R. Hicklin</b>		
Address:	<b>Route #2, Park Road, Charlotte, N. C.</b>		
Purpose of Bldg.:	<b>Residence</b>		No. Dwelling Units: <b>1</b>
Bldg. Ground Area:	<b>1500</b>	No. Stories:	<b>split level</b>
No. Habitable Rms.:	<b>6</b>	No. Bath Rms.:	<b>2</b>
		Bsmnt.?	<b>no</b>
Estimated Cost:	<b>\$13,000.00</b>	(Nearest 100)	Contract? <b>yes</b>
To be installed but not included in above cost:	Work to be done by the following:		
Electrical :	<b>\$500.00</b>	<b>Fink Electric Co.</b>	
Plumbing :	<b>200.00</b>	<b>Standard Plbg. Co.</b>	
Heating :	<b>200.00</b>		
Sprinklers :			
Other :			
		Connected to City System?	
Total Cost :	<b>\$15,000.00</b>	Water? <b>yes</b>	Sewer? <b>yes</b>

Map No.	Census Tract:
N. —	<b>48</b>
E. —	
Zone: <b>R1 700</b>	
Occupancy:	<b>Residence</b>
Type of Const.:	<b>Brick Veneer</b>
Fire Limits?	
Setback?	
Plans?	
Septic Tank:	
Council:	
Raleigh:	
Traffic Engr.:	
Health:	<b>42</b>
Bond? <b>yes</b>	License?
Incinerator?	
Type Heat:	<b>gas</b>
Fuel:	
Type Chimney:	No. <b>2</b>
<b>T. C.</b>	
Size:	<b>12x12 &amp; 6x12</b>

To the Inspection Department  
City of Charlotte, N. C. Date of Application: **Feb. 15, 1961**

The undersigned hereby makes application to  build  repair  remodel  move  demolish  \_\_\_\_\_ a building or structure at the location designated above and agrees to conform to all applicable laws of the City of Charlotte and the State of North Carolina.

Remarks: \_\_\_\_\_

Signature of Applicant: **G. R. Hicklin**  Contractor  
 Owner